

Existing landscaping / boundary treatments to be revised.
Refer to Dermot Foley Landscape Architects documents for details.

Masonry repair (masonry collapse at corner in accordance)

Existing non-original rooflight to be removed and slate roof made good to match existing in accordance with DSCA specifications

Existing internal partition wall to be removed in accordance with DSCA specifications

Wall to be repaired and a lime based plaster to be applied

Section of extension constructed on top of stone boundary wall to be carefully removed and wall to be reinstated to match existing in accordance with DSCA specifications.

GF/02 Bed 02
GF/03 Kitchen
New skirting, new ceiling
New coving, new floor
Original plaster to be retained and repaired
Non-original window to be made good in accordance with (no repairs are required)
Remaining plasterboard to be removed
Cementitious lined render to be hacked off and replaced with a lime based render in accordance with DSCA specifications
Reinstate existing doors
GF/04 Bath
GF/05 Bed 01
New skirting, new ceiling
New coving, new floor
Original plaster to be retained and repaired
Non-original window to be made good in accordance with DSCA specifications (no repairs are required)

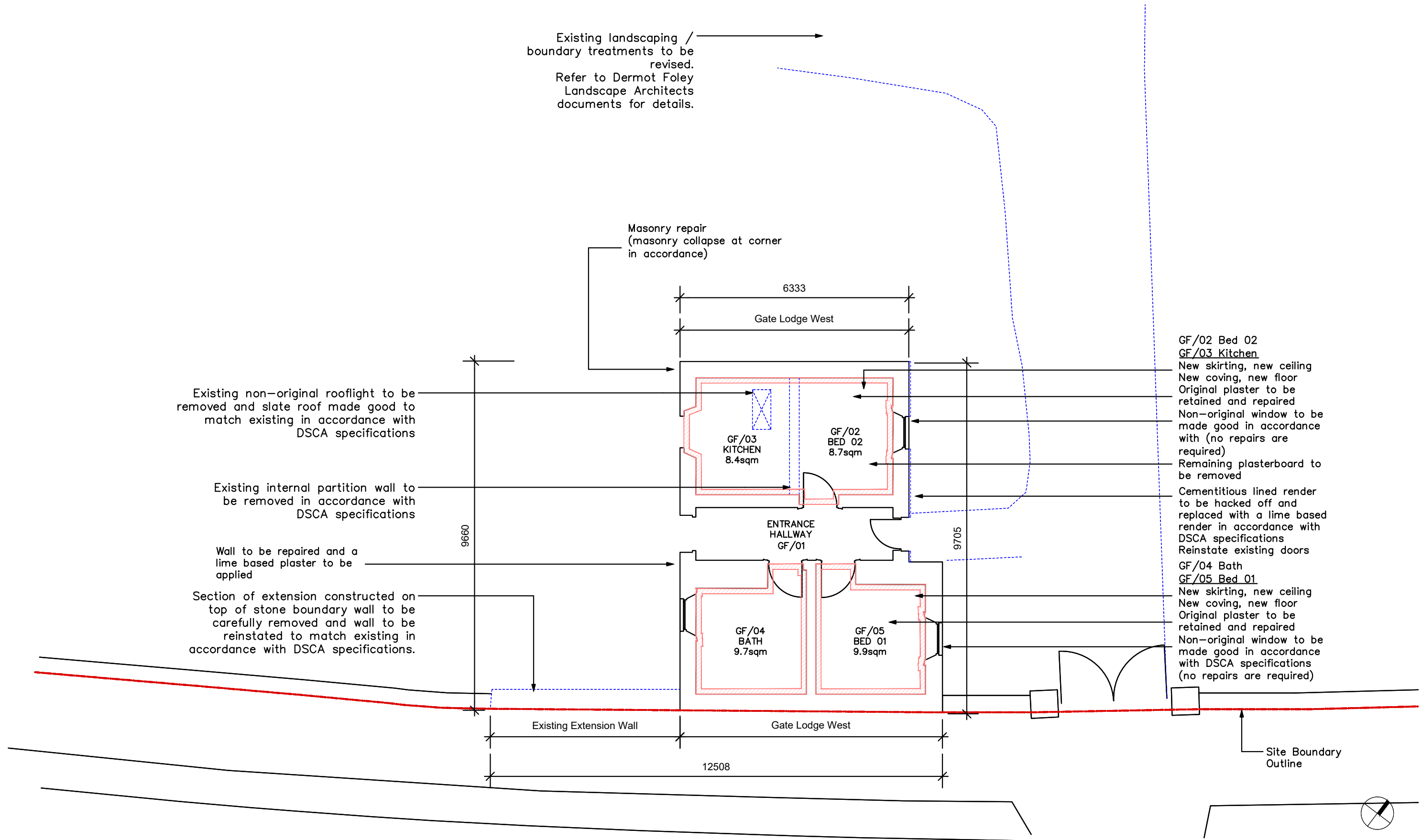

Gate Lodge, Existing Ground Floor Plans

*All dimensions in millimeters.
All levels (in meters) are related to Malin Head levelling datum.

Legend	Floor Areas (Proposed)	Material Key
Existing	3 Bed, 4 Person House Ground Floor Area = 128m ² Existing = 50.5m ² Proposed = 77.5m ² Demolitions = 41.9m ² Total Floor Area = 128m ²	AD Aluminium clad door
Proposed		AW Aluminium clad window
Demolitions - Non Original Fabric		BA Brick screen to AW
Demolitions - Original Fabric		BR Brick finish
Removal and Relocation of Original Fabric		CB Concrete block finish
		SC Stone coping / sill
		SR Slate roof finish
		ST Stone finish
		TD Timber door
		TF Timber finish
		TR Terracotta ridge / hip tiles
		TW Timber window
		WP Waterproofing
		MR Metal roof finish
		RF Render finish

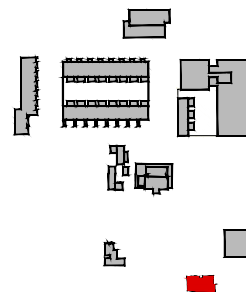

Revision Description	Date	Rev. No.	Issued by
LRD Stage 2 Submission	07-06-2024	C02	SK
LRD Stage 3 Submission	23-10-2024	C03	SK

Any reference to fire safety design or performance is presented for coordination purposes only. Refer only to the granted Fire Safety Certificate, and fire consultant's information for fire safety design, specification and performance.
Figured dimensions only to be used. This drawing is copyright of O'Mahony Pike Architects Ltd. All information is shared as per approved use in accordance with ISO19650-2:2018, Table 5; Standard Codes for Suitability of Models and Documents and the BEP. If the 'Status' field is empty, this information has been shared at 50 - WIP.

mahony pike

architecture | urban design | Dublin | Cork
 email: info@omahonypike.com | The Chapel | One South Mall
 tel: +353 1 202 7400 | Mount St. Anne's | Cork City
 fax: +353 1 283 0822 | Milltown, Dublin 6 | Co. Cork
 www.omahonypike.com | D06 XN52 Ireland | T12 CCN3 Ireland

Project Code: ---
 Project Lead: SD
 Drawn By: SK
 Job No.: 1307G
 Purpose: LRD Stage 3 Submission

Scale @ A3: 1:100
 Date Printed: 23-10-2024
 Current Rev.: C03
 Status: A3

Project: Knockrabo Phase 2
 Location: Mt. Anville Road, Dublin 14
 Client: KIDAC

Drawing Title: Gate Lodge, Existing Ground Floor Plans
 Drawing No.: 1307G-OMP-GL-00-DR-A-1900